

THIS COPY IS PROVIDED ON A RESTRICTED BASIS AND IS NOT TO BE USED IN ANY WAY DETRIMENTAL TO THE INTERESTS OF PANDUIT CORP.

PANDUIT PART NUMBER	A CONDUCTOR RANGE	WIRE DIAMETER RANGE - IN	STUD SIZE	HEX NUT	BODY HEX	H ONE CABLE	C	RoHS COMPLIANT
SP1-8-C	12 SOL - 8 STR	.081-.146	1/4-20	.50 [ 13 ]	.38 [ 9 ]	.63 [ 16 ]	.50 [ 13 ]	N/A
SP1-8L-C	12 SOL - 8 STR	.081-.146	1/4-20	.50 [ 13 ]	.38 [ 9 ]	.63 [ 16 ]	1.00 [ 25 ]	N/A
SP1-7-C	8 SOL - 7 STR	.128-.164	1/4-20	.69 [ 17 ]	.50 [ 13 ]	.88 [ 22 ]	.50 [ 13 ]	N/A
SP1-7L-C	8 SOL - 7 STR	.128-.164	1/4-20	.69 [ 17 ]	.50 [ 13 ]	.88 [ 22 ]	1.00 [ 25 ]	N/A
SP1-4-C	10 SOL - 4 STR	.102-.232	5/16-18	.75 [ 19 ]	.56 [ 14 ]	.94 [ 24 ]	.56 [ 14 ]	N/A
SP1-4L-C	10 SOL - 4 STR	.102-.232	5/16-18	.75 [ 19 ]	.56 [ 14 ]	.94 [ 24 ]	1.00 [ 25 ]	YES
SP1-3-C	6 SOL - 3 STR	.162-.260	3/8-16	.81 [ 21 ]	.63 [ 16 ]	1.06 [ 27 ]	.63 [ 16 ]	N/A
SP1-3L-C	6 SOL - 3 STR	.162-.260	3/8-16	.81 [ 21 ]	.63 [ 16 ]	1.06 [ 27 ]	1.13 [ 29 ]	N/A
SP1-2-C	4 STR - 2 STR	.232-.292	3/8-16	.88 [ 22 ]	.69 [ 17 ]	1.06 [ 27 ]	.63 [ 16 ]	N/A
SP1-2L-C	4 STR - 2 STR	.232-.292	3/8-16	.88 [ 22 ]	.69 [ 17 ]	1.06 [ 27 ]	1.13 [ 29 ]	YES
SP1-1/0-L	6 SOL - 1/0 STR	.162-.375	1/2-13	1.00 [ 25 ]	.75 [ 19 ]	1.31 [ 33 ]	.75 [ 19 ]	N/A
SP1-1/0L-L	6 SOL - 1/0 STR	.162-.375	1/2-13	1.00 [ 25 ]	.75 [ 19 ]	1.31 [ 33 ]	1.25 [ 32 ]	N/A
SP1-2/0-Q	1 SOL - 2/0 STR	.289-.419	1/2-13	1.13 [ 29 ]	.88 [ 22 ]	1.44 [ 37 ]	.75 [ 19 ]	YES
SP1-2/0L-Q	1 SOL - 2/0 STR	.289-.419	1/2-13	1.13 [ 29 ]	.88 [ 22 ]	1.44 [ 37 ]	1.25 [ 32 ]	YES
SP1-4/0-Q	3/0 SOL - 4/0 STR	.410-.528	5/8-11	1.38 [ 35 ]	1.13 [ 29 ]	1.69 [ 43 ]	1.00 [ 25 ]	YES
SP1-4/0L-Q	3/0 SOL - 4/0 STR	.410-.528	5/8-11	1.38 [ 35 ]	1.13 [ 29 ]	1.69 [ 43 ]	1.50 [ 38 ]	YES
SP1-350-12	4/0 STR - 350 kcmil	.528-682	5/8-11	1.50 [ 38 ]	1.25 [ 32 ]	2.00 [ 51 ]	1.00 [ 25 ]	N/A
SP1-350L-12	4/0 STR - 350 kcmil	.528-682	5/8-11	1.50 [ 38 ]	1.25 [ 32 ]	2.00 [ 51 ]	1.50 [ 38 ]	N/A
SP1-500-12	250 kcmil - 500 kcmil	.575-.815	3/4-10	1.81 [ 46 ]	1.50 [ 38 ]	2.31 [ 59 ]	1.38 [ 35 ]	YES
SP1-500L-12	250 kcmil - 500 kcmil	.575-.815	3/4-10	1.81 [ 46 ]	1.50 [ 38 ]	2.31 [ 59 ]	1.75 [ 44 ]	N/A

NOTES:

1. MATERIAL: HIGH COPPER CONTENT HARD DRAWN ROD
2. USED FOR CONNECTING CONDUCTORS TO VARIOUS SIZES OF TAPPED HOLE
3. DIMENSIONS IN BRACKETS ARE MILLIMETERS.
4. SEE WWW.PANDUIT.COM FOR PACKAGE QUANTITIES

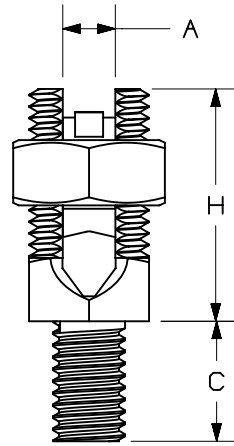

LISTED



DB RATED

PART NUMBER		SEE TABLE	
TITLE			
BRONZE SERVICE POST CONNECTOR - SP1 SERIES			
CUSTOMER DRAWING			
ITEM REVISION NAME		N41213BA/03	
DATASET FILE NAME		N41213BA-DC/03A	
		THIRD ANGLE PROJECTION	
MATERIAL		SEE NOTES	
DRAWING NUMBER		N41213BA-DC	
DRAWN BY	DATE	CHK	SCALE
TM	7-97	TM	NONE
SHEET 1 OF 1		A	

03A	7-24-23	JHNU	JHNU	MRWA	C. REVISED DRAWING NUMBER: N41213BA-DC WAS C41213 B. ADDED RoHS COMPLIANT COLUMN A. CONVERTED TO NX	133002
REV	DATE	BY	CHK	APR	DESCRIPTION	ECN